

MLT6 SERIES

Mobile Light Towers

GENERAC[®]

MAGNUM



MLT6

MOBILE LIGHT TOWERS

Generac Magnum MLT6 series mobile light towers provide low maintenance, reliable lighting in a compact footprint. The large fuel capacity and 750-hour service interval mean more uptime and less labor costs. The new and improved MLT6SMD LED light tower now provides more than twice the luminosity. Designed to deliver bright and even light coverage, the new LED fixtures outperform metal halide bulbs in durability, longevity and efficiency, allowing for an extended runtime of up to 205 hours. MLT6 towers also provide up to 6kW of export power for tools and electronics. Externally illuminated controls and rear LED trailer lights improve visibility and operator safety. The gas-assisted rear hatch opens easily, and stays secure, for quick and easy unobstructed maintenance access.

MLT6SMD Features & Benefits

POWERFUL

- Powerful and efficient LEDs offer better performance than 1050W metal halide bulbs
- Up to 6kW of available export power for tools and electronics

DURABLE

- Robust LED fixtures are rated IP68 for excellent protection against the ingress of water and dirt
- Long-lasting and durable LED modules are designed to last the lifetime of the tower

COST-EFFECTIVE

- Lower fuel consumption; save on fuel costs and labor
- Long, 750-hour service interval requires less downtime

EASY TO USE

- Standard Power Zone Autolight controller offers programmable settings for automated control, including scheduled start/stop and a dusk-to-dawn sensor
- Instant light; no waiting for warm-up or cool-down of lights

QUIET

- As low as 63dBA at low speed

APPLICATIONS

- Construction
- Events
- General Rental
- Roadwork

FLIP HOOD

Gas-assisted pistons make raising and lowering the hood effortless; easy access for maintenance and enhanced operator safety

LARGE FUEL CAPACITY

enables longer runtimes and less fill-ups



GENERAC® LEDs



● **UNIQUE MODULE DESIGN** provides even light coverage

● **LONG LASTING LED** modules have a life expectancy of 10 years; backed by a 5-year warranty

● **DURABLE LED** modules are made with impact-resistant plastic and rated IP68 for ingress protection

● **FIXTURES** can be controlled independently; use one to four lights as desired



● **VERTICAL MAST** for fast and easy deployment and more compact storage

● **FULLY ROTATIONAL MAST** is safely adjusted from the ground

MLT6SM/K

● **ERGONOMIC 2-handled manual winch** standard; electric winch option

● **RAISED SIDE EXHAUST** to minimize ground staining

● **LED trailer lights** enhance jobsite visibility and safety

● **COMPACT STORAGE AND TRANSPORT SIZE;** up to 17 towers on a 48 foot flatbed truck

● **CORROSION-PROOF POLY SHELL** withstands tough applications and looks better longer



SPECIFICATIONS

Additional options available

	MLT6SMD	MLT6SM	MLT6SK
	USA (METRIC)		
Engine / Tier	Mitsubishi / Final Tier 4	Mitsubishi / Final Tier 4	Kubota / Final Tier 4
Prime	10.5 hp @1800 RPM	10.5 hp @ 1800 RPM	11.7 hp @ 1800 RPM
Power Rating: kW	6	6	6
Output: Amps	66	50	50
Fuel Capacity: gal (L)	39.9 (151.04)	39.9 (151.04)	39.9 (151.04)
Est. Fuel Consumption @ Full Load: gph (Lph)*	0.549 (2.078)	0.47 (1.78)	0.50 (1.89)
Est. Fuel Consumption w/ Lights Only: gph (Lph)*	0.195 (0.738)	0.31 (1.17)	0.33 (1.25)
Max Runtime w/ Lights Only: hrs*	205	128	119
Mast Height, Deployed: ft (m)	23 (7.01)	23 (7.01)	23 (7.01)
Power Zone® Autolight Controller	Standard	Optional	Optional
Electric Winch	Optional	Optional	Optional
Light Fixtures	(4) 296W LED	(4) 1,050W MH	(4) 1,050W MH
Total Luminous Flux (Lumens)	172,200	462,000	462,000
Dimensions, Mast Stowed: in (m)	118 x 57 x 101 (3.0 x 1.45 x 2.6)	118 x 57 x 101 (3.0 x 1.45 x 2.6)	118 x 57 x 101 (3.0 x 1.45 x 2.6)
Operating Weight: lbs (kg)	1641 (744.35)	1603 (727.11)	1623 (736.18)
Dry Weight: lbs (kg)	1340 (608)	1290 (585)	1330 (603)
Max Wind Rating: mph (kph)	65 (105)	65 (105)	65 (105)
CSA Approved	Yes	Yes	Yes

Specifications are subject to change without notice

*Results based on engine manufacturer and field test data after 100-hour engine break-in period and may vary based on factors including age and maintenance of equipment, environmental conditions and fuel density. Consult the Owner's Manual for fuel and maintenance recommendations.



- POWER ZONE AUTOLIGHT CONTROLLER** with programmed controls, including dusk-to-dawn sensor (Standard on MLT6SMD)
- ADVANCED TELEMETRY INTERFACING** allows for remote monitoring and location and recovery assistance
- EXTERIOR ILLUMINATED CONTROLS** for enhanced operator visibility and safety
- PAD-LOCKABLE CONTROL PANEL COVER** for added security
- EXTERIOR CONVENIENCE OUTLETS** for job site power needs

120 VAC 20 Amp GFCI duplex outlet (NEMA 5-20R type)
240 VAC 30 Amp twist lock outlet (NEMA L6-30R type)

LIGHT TOWER COVERAGE

MLT6SMD LIGHT TOWER COVERAGE

23-foot mast height at 20-degree fixture tilt

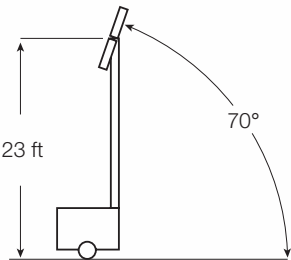
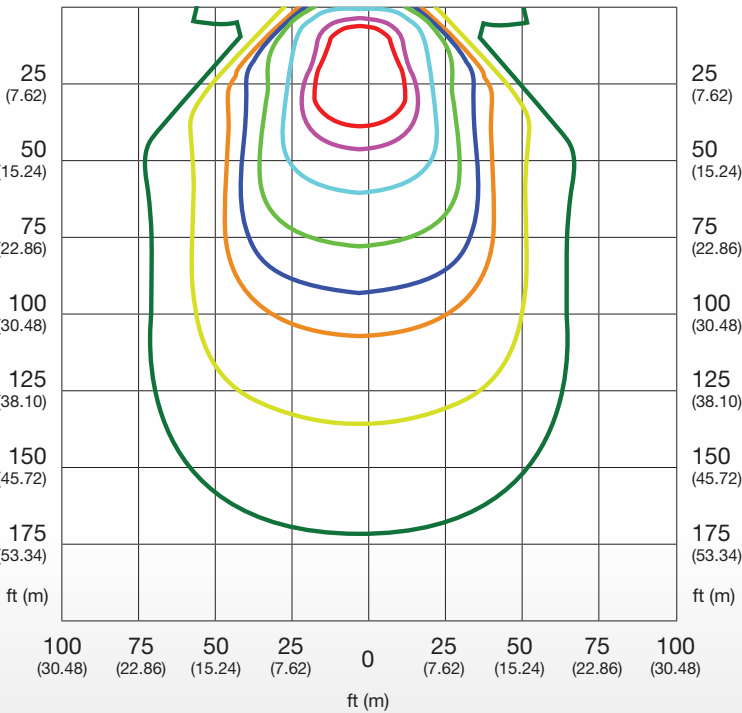

- 30 foot candles
- 20 foot candles
- 10 foot candles
- 5 foot candles
- 3 foot candles
- 2 foot candles
- 1 foot candles
- 0.5 foot candles

MLT6SM/K LIGHT TOWER COVERAGE

23-foot mast height at 20-degree fixture tilt

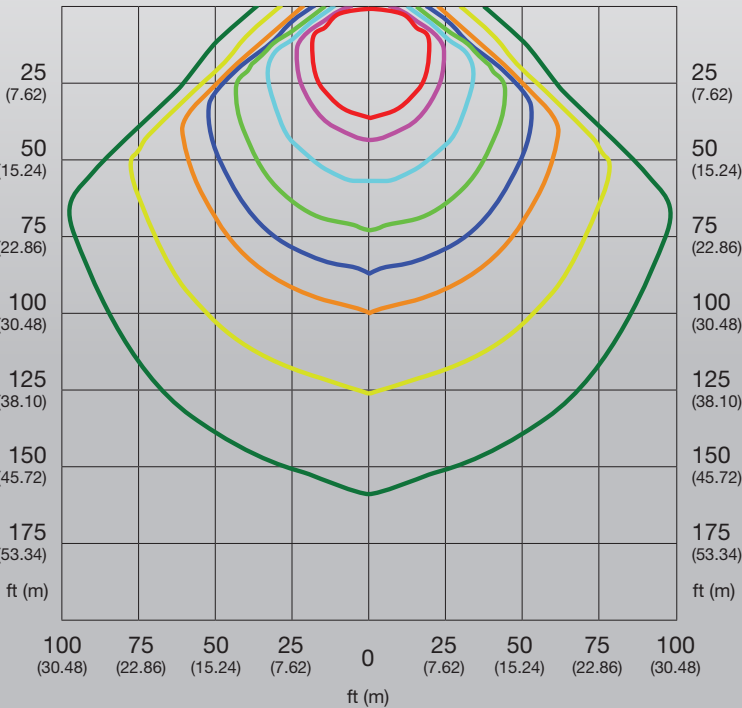



Looking for more light?

Generac Mobile Products offers a full line of powerful, mobile lighting solutions for every need. For our complete line of light towers, visit GeneracMobileProducts.com.

24/7 • 365 Nationwide Service Support Network;

because when you're on the job, we're on the job.

LIGHT TOWERS | GENERATORS | PUMPS | HEATERS



*Assembled in the USA using domestic and foreign parts

Part No. 0202560 01/2018

©2018 Generac Power Systems, Inc. All Rights Reserved.
Specifications are subject to change without notice.

GENERAC | **MOBILE PRODUCTS**

Generac Mobile Products, 215 Power Drive, Berlin, WI 54923
GeneracMobileProducts.com | 800-926-9768 | 920-361-4442